

## F PERIODICAL MAINTENANCE

### 5. PERIODICAL MAINTENANCE PROCEDURE bizhub PRESS C7000/C7000P/C70hc/C6000, bizhub PRO C6000L

#### 5.12 Reverse/exit section

##### 5.12.2 Replacing the paper exit drive gear, paper exit de-curler roller

###### (1) Periodically replaced parts/cycle

- Paper exit drive gear: Every 1,000,000 prints
- Paper exit de-curler roller: Every 1,000,000 prints

###### (2) Procedure

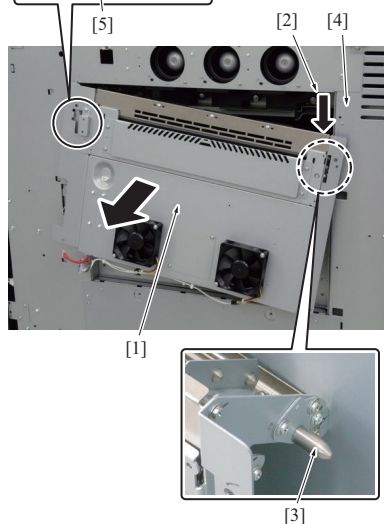
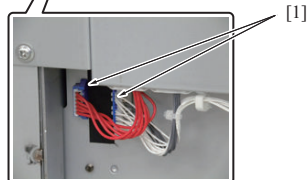
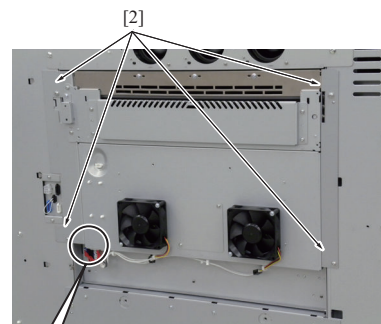

1. Remove the left cover. (Refer to [G.2.2.2 Left cover](#))
2. Pull out the duplex section. (Refer to [F.5.11.1 Replacing the intermediate conveyance clutches /2 \(CL4\) and /3 \(CL5\)](#))
3. Remove 2 connectors [1].
4. Remove 4 screws [2].

5. Lower the front side [2] of the paper exit unit [1], and then remove the paper exit unit while paying attention not to hit the frame [4] with the pin [3].

###### Note

- When reinstalling the paper exit unit, be sure to insert the pin [5] to the frame first.

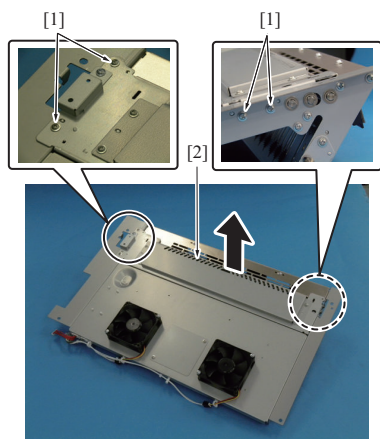

6. Remove 4 screws [1], and then remove the reinforcing plate /Lt [2].

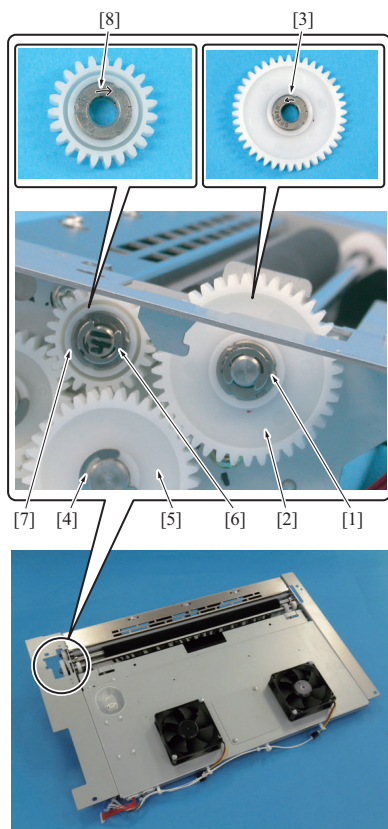

7. Remove the E-ring [1], and then remove the paper exit drive gear [2].

**Note**

- When reinstalling the gear [2], be sure to set it with its arrow-marked side [3] on the E-ring side [1].

8. Remove the E-ring [4] and remove the gear [5].

9. Remove the E-ring [6] and remove the gear [7].

**Note**

- When reinstalling the gear [7], be sure to set it with its arrow-marked side [8] on the E-ring side [6].

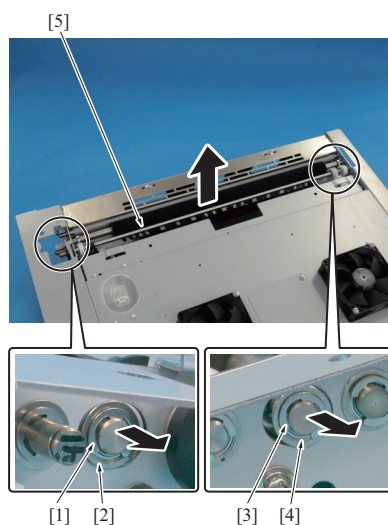

10. Remove the E-ring [1] and remove the bearing [2].

11. Remove the E-ring [3] and remove the bearing [4].

12. Remove the paper exit de-curler roller [5].

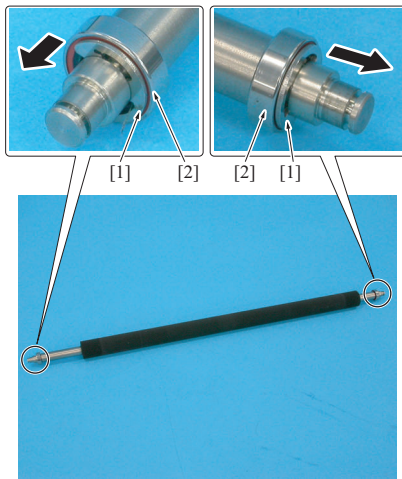

a03uf2c075ca

13. Remove the E-rings [1], 1 each, and remove 2 bearings [2].
14. Reinstall the above parts following the removal steps in reverse.
15. After replacing the paper exit de-curler roller, conduct the following items.  
Counter reset of the parts counter No.126